

1 2 3 4 5 6

A

B

C

D

A

B

C

D

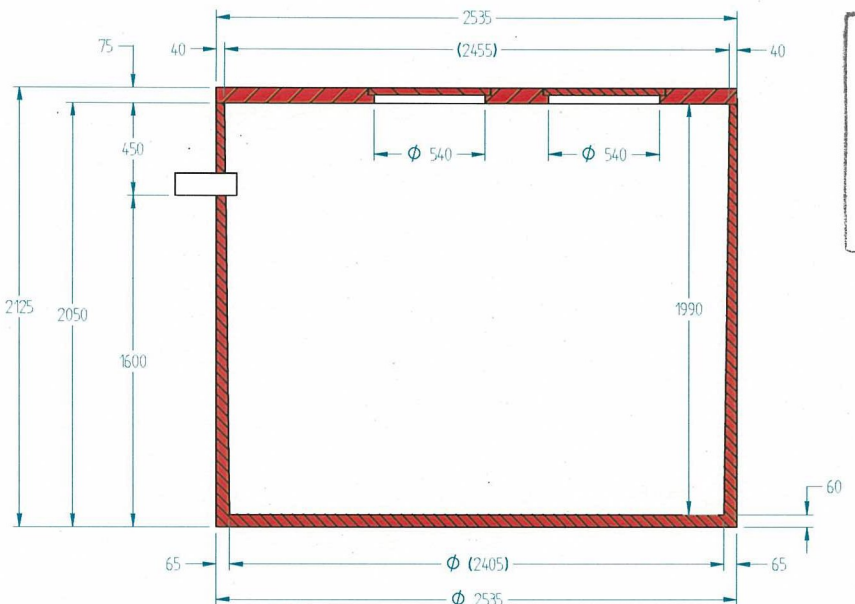
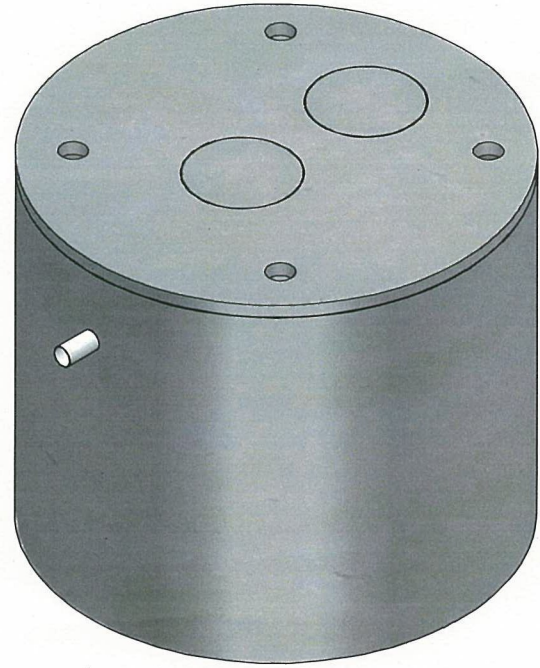
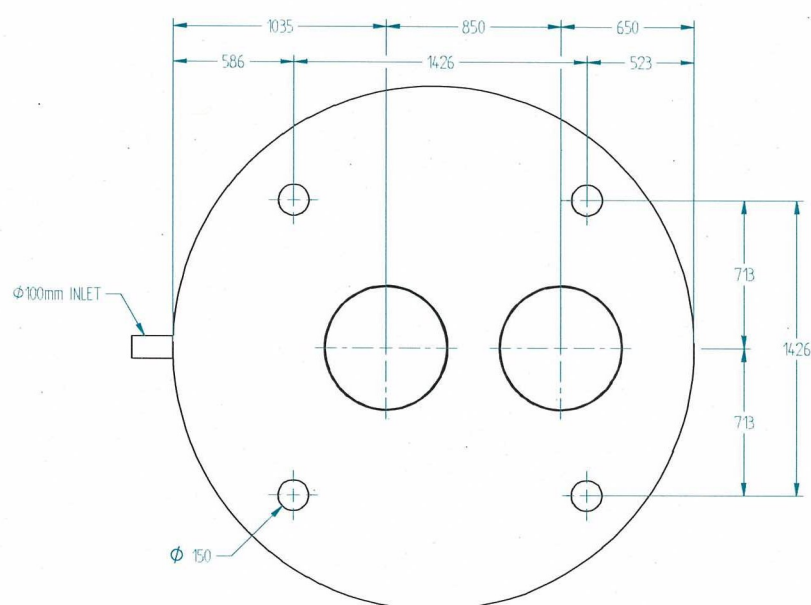

APPROVED
 1 8 AUG 2010
 DEPARTMENT OF HEALTH, N.S.W.

NOTES:

1. SEPTIC TANKS TO BE MANUFACTURED AND TESTED IN ACCORDANCE WITH AS/NZS 1546.1:2008
2. CONCRETE STRENGTH = 40MPa
3. CONCRETE TO BE VIBRATED TO ENSURE WELL COMPACTED CONCRETE
4. TANKS TO BE REINFORCED WITH FIBRE STEEL
5. LIFTING TO BE "REID SWIFT LIFTS" 4 x 2.5 TONNE FOOT ANCHORS CAST INTO BASE OF THE TANK, 3 x 1.3 TONNE ANCHORS CAST INTO TANK LIDS

 <small> AERATED WASTEWATER TREATMENT SYSTEMS </small>	<small>UNLESS OTHERWISE SPECIFIED ALL DIMENSIONS ARE IN MM</small>	<small>PROJECT</small> COLLECTION WELL	<small>SHEET SIZE</small> A3
	<small>SCALE</small> 1:1 (DO NOT SCALE)	<small>DATE PLOTTED</small> 27/07/2010	
<small>COPYRIGHT</small> <small>THIS DRAWING AND PROJECT OR CERTIFICATE UNDER REMAINS THE PROPERTY OF ECONOCYCLE AND CANNOT BE COPIED OR REPRODUCED WITHOUT WRITTEN PERMISSION</small>	<small>DRAWN BY</small> P. MCKAY	<small>DRAWING LAST MODIFIED BY</small> P. MCKAY	<small>REVISION</small> 1.0
	<small>MODELLED BY</small> P. MCKAY	<small>MODEL LAST MODIFIED BY</small> P. MCKAY	<small>SHEET No</small> 1 OF 1
		<small>PART#</small> 124_0910	

1 2 3 4 5 6